

The Outerspace

Garden Design

Landscaping

Planting

Water Gardens

Lighting

Maintenance

Consultancy

Aftercare

*Design and deliver
portfolio*



South Circular garden

This project initially offered an extremely rigid framework from which to work. Budgets would not allow for major earthworks and retaining wall construction and offered many tricky challenges due to gradients, position of apartment in the garden. Security and most of all privacy were important factors.

The solution came through studying and evaluating all the levels through the site, the simple solution would be for the change in levels to be reduced in number as well as in height. This would offer a wider area between house and first step to upper level as well as changing the relationship between heights at the door step.



This allowed more fluidity between inner and outer spaces. The incorporation of a bench seat with a high back allowed the form and function to follow each other, supplying a seat throughout the year as well as allowing a table and only one row of chairs, enough to dine in an extremely sheltered sunny spot. This also offered partial sound insulation and privacy without compromising light entering the apartment, actually increasing reflected light values. The top of the high back bench also doubles up as a sun lounger or impromptu spot to sit and snack.



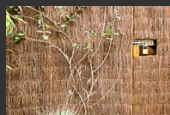
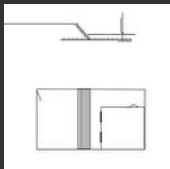
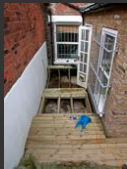
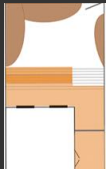
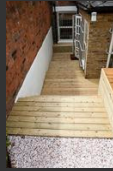
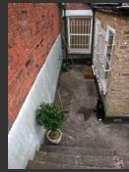

The top of the high back bench also doubles up as a sun lounger or impromptu spot to sit and snack.

Planting for the rear fence was chosen to give height, privacy and soft protection to the garden from a busy part of the south circular in Clapham as well as improving security. In time this will be further softened by the climbing planting.



Circles ~ levels ~ forms

A small urban garden in need of a redesign to give privacy and a sanctuary for relaxation which was based around a circular paved area in order to break away from the straight lines of the house and surrounding environment. Colour, a water feature, luscious planting and atmospheric lighting all added to make this space a tranquil haven with a loose nod to a Mediterranean feel.

In the front, the space was an empty void that need constant care and maintenance but was not somewhere where you would sit and enjoy with privacy from the heavy traffic and noise. For this reason, tiered terraces were added and an abundance of planting to create a wild tranquil oasis of colour shape and form. Tall bamboos at the very front (planted to hide) hid the garden from buses, traffic and pedestrians.



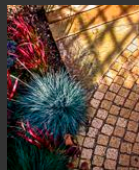
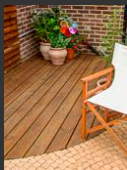
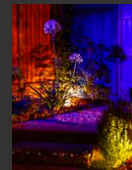
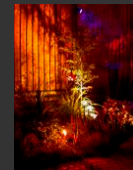
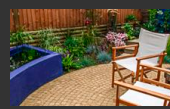

10 year later



Minimalist simplicity ~ Cheam

Requiring a low maintenance, child friendly garden, the brief was to create a space that brought inner and outer space together visually as well as in levels. With considerable height differences between inner and outer, access of flow needed major changes. We were to break down the garden to it's bare minimal elements and very importantly create an area in which to barbecue whilst using Astro turf!

The rear boundary faced onto a school (as strangely many of our projects seem to!) and lost in a slurry of neglect, trees, shrubs and knotted ivy. We spent much time and budget sorting out these aspects before being able to get on with the fluid, dynamic and minimalist design. The shed was later painted to match the fence.

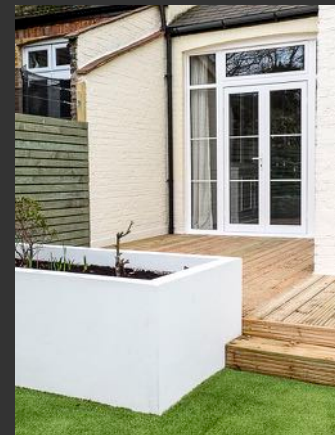





Play and entertain

Urban garden space heavily overlooked which required privacy, security and a wonderful, safe and secure space for a child to play. Client required simplicity and versatility on a base budget

Extra security is provided by wire rails for a climber. In time this will also add extra privacy in summer yet still allowing more light in winter and providing white powdered spiralling stalks in winter.



A simple impromptu seat was added to both planters.

A diffusion screen has been placed on the outside to stop prying eyes and offer a slippery surface that is difficult to scale.



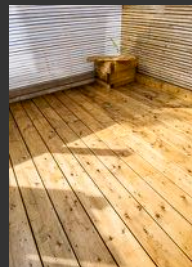
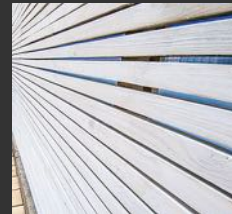

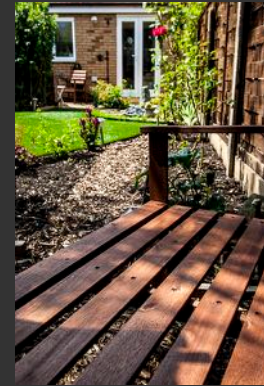

Found Objects

This garden had lots of statues and figures inherited from previous owners and the brief was to keep them for consistency. Also the garden had a legacy of bindweed (or convolvulus, a climber that invades and is hard to rid of) which had to go. Client wanted to keep part of the character of the garden, one of the reasons she bought the property. A few design considerations were required such as low maintenance, a pond and water feature, astroturf and raising of the fences, there were no overall style or ideas for the space, so finding our brief was a challenge. Not being given any stylistic reference of an art piece, another garden, outer space, landscape or a piece of music or poetry for inspiration, all of which have been the basis of previous designs. Where was the style to come from?



Unperturbed Martin looked around the inner space to find some prints and from these came the final feel and design. The project evolved over 2 years for budgetary reasons which also allowed us to make sure the bindweed was fully dead and gone before the final implementation stages.

Further creative thinking was required as the overall budget was base level which meant being extremely resourceful so additional could be added such as lighting. Recycling onsite was enhanced by a simple yet very efficient compost heap.



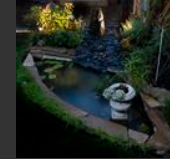
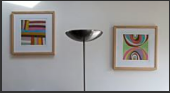

10 Years later



10 Years later



North African inspired

Our brief was to create a light filled sun trap of warmth and simple comfort whilst addressing the flow and change of levels between the inner and outer spaces in this south facing garden. Keeping the existing abundance of planting and being low maintenance.

Having spent much time in North Africa Martin was able to use his sense of light and shadow to recreate the feeling of bright light contrasted against dapple and shade along with a rustic simple more modern minimalist twist.

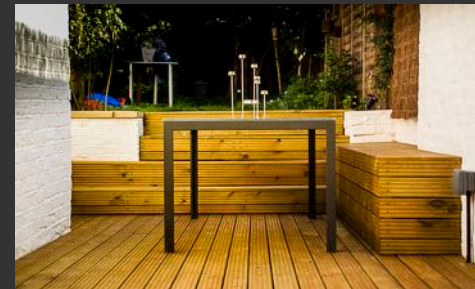

With the width so narrow the best option was to create a permanent bench seat on one side so table and chairs could be added and moved around. This also allowed for storage and impromptu perching when furniture was away. A day bed on the other side. The planting was so out of shape it required heavy pruning and a structure was created over which it could grow. Lighting was added to add the light and dapple at night.



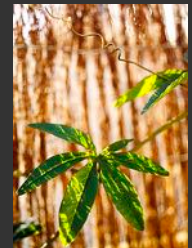
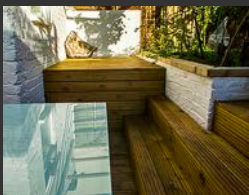
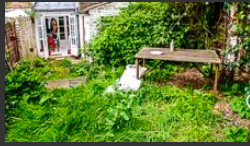



From start to finish

This is probably the longest running project for Outerspace. Having held the families hand since 2008. Seeing them through child unfriendly invasive weeds and exploding mushrooms, protecting resident giant stag beetles, supporting them through new extensions, to finally bringing them a stage on which to perform! They are very musical!

Knowing that a damp old extension to the house would eventually be replaced, over a period of months we tidied up the garden to make it more child friendly and got rid of spikes, weeds and contained the existing planting. Our tree surgeon reduced the overshadowing oak to bring in more light and eventually the space was covered with landscape fabric and wood chip to get rid of the persistent weeds and the exploding mushrooms for good. Leaving a space and a pile of logs for the stag beetles to live in. In the front we replaced the gorgeous bespoke gate posts found only in this area along with a suitable gate and brought all the front hedging into sweeping curves. For many years the development went on hold whilst we still maintained the space as and when required.



Eventually a plan and development for the house was finalised and after completion we cleared up the horrible mess left by the builders to return the garden, so it could be used for play, performance and relaxation. Some years later we designed the final garden on a green concert hall as mother and daughters all play instruments gorgeously. Hence the wide variety of images from all the time and stages we've held their hand, for their inner and outer spaces to work for them and their ever changing circumstances.



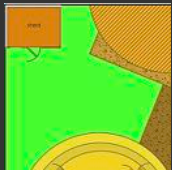
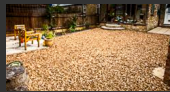

Giant Stag Beetle home during building works





Small but perfectly formed

Our brief was simply to create a low maintenance garden with suitable planting and provide a relaxing play area for a 1st floor maisonette. The site was the smallest project we have ever undertaken. With no side access, the space was also shared with the downstairs neighbour to which openness and the sense of shared space was to continue yet create a new identity to the garden. Providing a clothes drying area was also requested as indoor space was limited, we used this creatively to double up as a "roll out" pulley system line the whole length of the garden. The clothes can be attached to the line upstairs, negating the need to even go into the garden whilst maximising air flow, reducing drying time. This also allowed large cloths and sheets to be drawn across when more privacy was required.



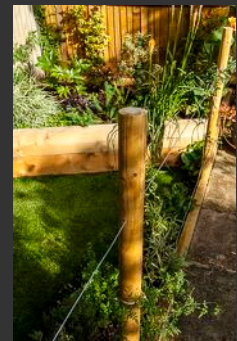

Pure Design

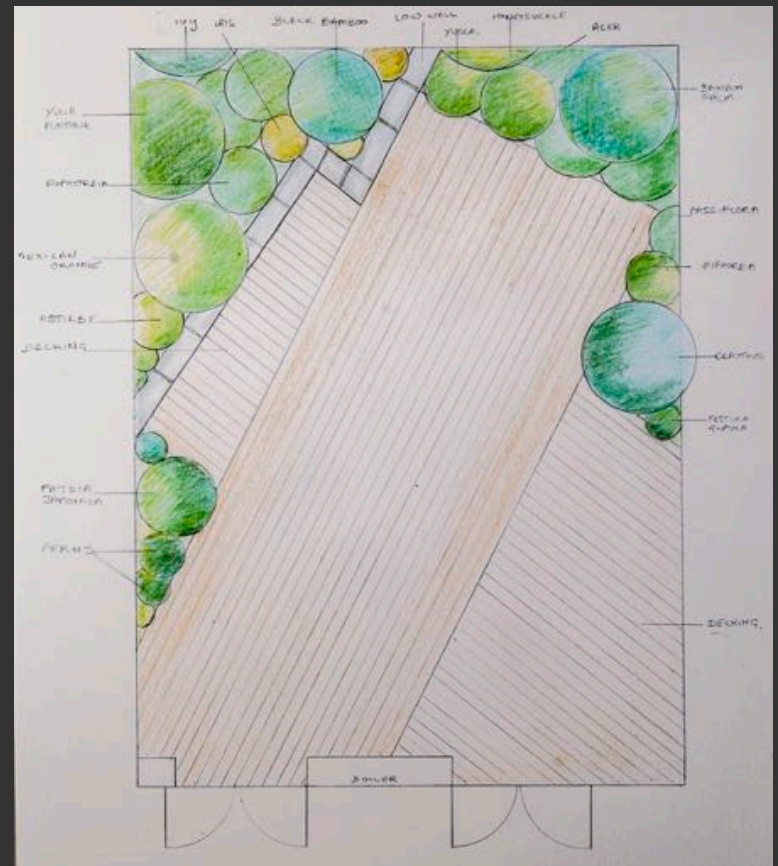

We also design plans both structural; & planting plans for your own contractors to instigate

About the Outerspace

The Outerspace has been creating fabulous outer spaces for over twenty years. The experience and practice involved has been a life time.

The main driving force behind The Outerspace, chief designer and project manager, Martin Breschinski; originally trained in building, surveying and civil engineering, followed later by an arts degree. For many years he has practiced as a professional commercial and advertising photographer. Lighting, colour and form are essential elements of his work. Coming from 3 generations of horticulturalists, the Outerspace project is an opportunity to combine his extremely broad knowledge and experience to create a unique approach within 3D design and planting. Sighting his influences from architecture and design, pure physics, through to painting, sculpture, photographic practice and a passion for nature and the environment.

Creating stylish, minimalist and practical functioning extensions to your interior space, Outerspace design and install hard and soft landscaping solutions. They embrace a holistic approach to harness and recycle existing resources and materials, to build predominantly self-contained environments through using new and old technology. Enjoyment is maximised through imaginative lighting schemes.

Projects range from full redesigns to refreshing, renewing and maintaining of gardens. Many of our clients have employed our services over decades with some projects evolving over similar times due to budgets, building works due to happen and other considerations. In this we try to help and guide through the developing of houses into homes of beauty, interest and diversity, tailored to meet your requirements and vision. We consider the dynamics between the inner and outer spaces of your environment to establish a relationship of balance and integrity between the two. Contemporary gardens should reflect the way we live now and use materials and technology at our disposal today.

Garden lighting is a house speciality because of Martin's studio experience of many years. We adore playing with water in all it's forms and have created many features across the years whilst also installing irrigation systems often with highly original and innovative twists to make them as minimal in their consumption as possible. Some are fully off grid and collect from harvested water alone. With the use of many differing techniques our garden designs reduce the amount of water needed. Keeping them low maintenance with the least environmental impact possible. Composting is another specialist topic as we like our gardens to recycle as much as possible onsite whilst also teaching children the wonders of ashes to ashes, dust to dust.

Ultimately, once we have finished our work we try to support, nurture, and encourage our clients and families to get their hands in the soil, get down, dirty and involved. Alternatively we offer after care though most frequently we might come in twice a year to put the garden to bed for winter and major pruning and another time to develop and train the garden in summer.

Who we work for

Our clients come from all walks of life but we have established a firm client base amongst fellow creatives such as musicians, singers, actors, graphic designers and dancers.

If you have come here looking to the future, perhaps interior works are more pressing in time and resources presently. Should you like our style and feel it appropriate for you, we highly recommend that you contact us before interior works proceed. We cannot emphasise strongly enough that it is in your and our interest to do so.

There is little justification for exterior spaces to consume excessive nor unsustainable demands on our environment generally. Here we encourage the antithesis, seeing our outer spaces as the perfect place to incorporate sustainability, in the hope that it may move indoors, should it not have already done so! We encourage the use of designs that incorporate recycling, composting, water harvesting as well as the use of recycled and sustainable materials and products within construction. This has been a founding mission of the Outerspace, for which we have created many unique solutions to problems where existing solutions are not adequate or not on the scale required in the domestic arena. To the best of our ability, we try to use or recycle what is already on site rather than throwing one lot of materials away to bring back in a whole heap of new.

The key elements that are instrumental in our designs and thought processes are light, water, earth, air, wood, metal and fire. Loosely based on Chinese 5 element theory.

Budgets & costs

Having lots of money to spend on your garden is certainly useful, but certainly not everything in obtaining a gorgeous garden. We work creatively within your budget or alternatively work over a longer period of time to complete. Our projects often last many years as we are frequently requested to help maintain and develop the garden. This is wonderful for us to learn and see what works and what could be improved upon, making us better designers by learning from lots of experience. There is also the pleasure obtained from seeing the garden evolve into the vision we had envisaged as to what the garden would look like in 10 to 15 years time.

All estimates provided are highly detailed breakdowns of all aspects of the works scheduled. The process of finding the final cost is an intrinsic part of the design process; often elements of the design need to be altered, removed, added at a later date or juggled because of budgetary implications.

Some of our larger projects have been going on over many years as the client finds funds to complete another area of the garden. Most important is that there is an overall plan, which is designed in stages and in some cases clients may even undertake certain aspects themselves. es clients may even undertake certain aspects themselves.